

WARM ROOF – WALKABLE, COMBINED STRUCTURE, PLASTIC FOIL WATERPROOFING
PAVEMENT ON STANDS

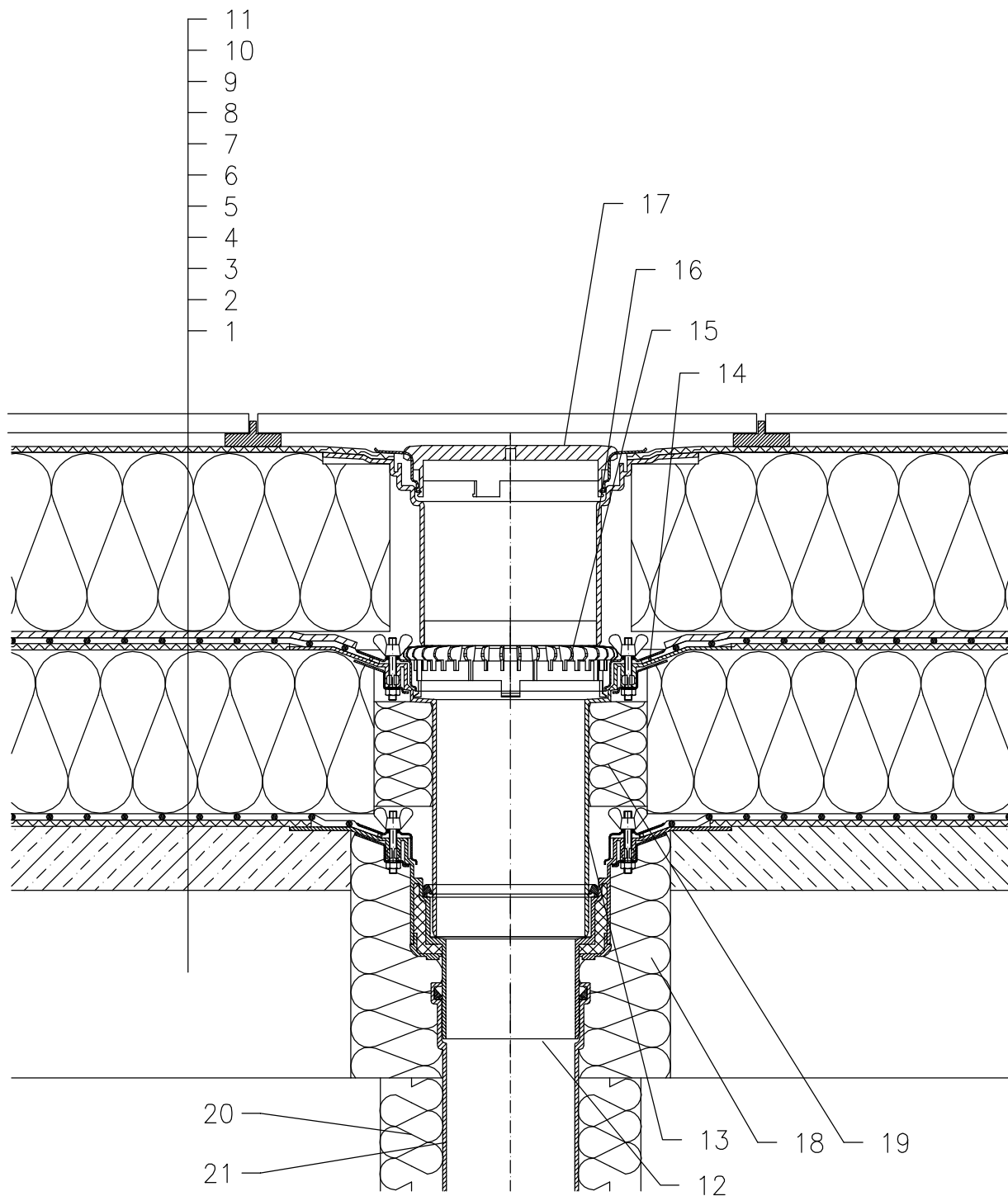

- 1 SUPPORT CONSTRUCTION
- 2 GRAVITY LAYER
- 3 DILATATION LAYER
- 4 MOISTURE STOP AND TEMPORARY SAFETY WATERPROOFING FROM PLASTIC FOIL
- 5 THERMAL INSULATION
- 6 DILATATION LAYER
- 7 PLASTIC FOIL WATERPROOFING LAID LOOSE
- 8 DRAINAGE LAYER
- 9 THERMAL INSULATION FROM XPS
- 10 DILATATION LAYER
- 11 PAVEMENT ON STANDS
- 12 FLAT-ROOF DRAIN HL62 WITH INSULATED DRAIN BODY, FLANGE AND STAINLESS STEEL CLAMPING RING
- 13 EXTENSION HL65 WITH FLANGE, STAINLESS STEEL CLAMPING RING AND LIP SEAL
- 14 SEALING PACKING (SEE DETAIL-ACCESSORIES)
- 15 GRAVEL GUARD HL160
- 16 EXTENSION HL350.1 WITH FLANGE AND WATERPROOFING KIT HL84.0
- 17 FLAT GRATE HL170
- 18 ASSEMBLY FOAM
- 19 FILL FREE SPACE WITH MINERAL WOOL
- 20 DOWNPIPE THERMAL INSULATION
- 21 DOWNPIPE

NOTE:

FLAT-ROOF DRAIN HL62.1 HEATED (230V, 10-30 WATTS) CAN BE USED.

ASSEMBLY INLET: $\phi 220$ MM, ALTERNATIVELY 240X360 MM